

Judicial Center Project Update

May 9th, 2017

Courtroom Needs

Court	Current Court Rooms	Current Courtroom Need	Anticipated 2035 Need
General District	1.5	2	3
Juvenile and Domestic	2.5	3	4

Additional Support Space Required:

- Commonwealths Attorney
- Court Security
- Court Services Unit
- Court Clerk Offices
- Victim Witness
- Building Support (i.e. Public Restrooms, etc)

Current Phase Project Objectives

- Phase 1
 - Approx. 32,500 square foot building addition
 - 2 courtrooms to be constructed now
 - Sufficient shell space for 2 additional courtrooms for 20 year needs
 - Enclosed building connector corridor
 - Existing Space Renovations
 - Light renovation to first floor Building “C”
 - General District Clerk to occupy space
 - Commonwealth’s Attorney to use existing General District Clerk Space
 - Requires relocation of existing Museum annex

Approved Project Phase 1

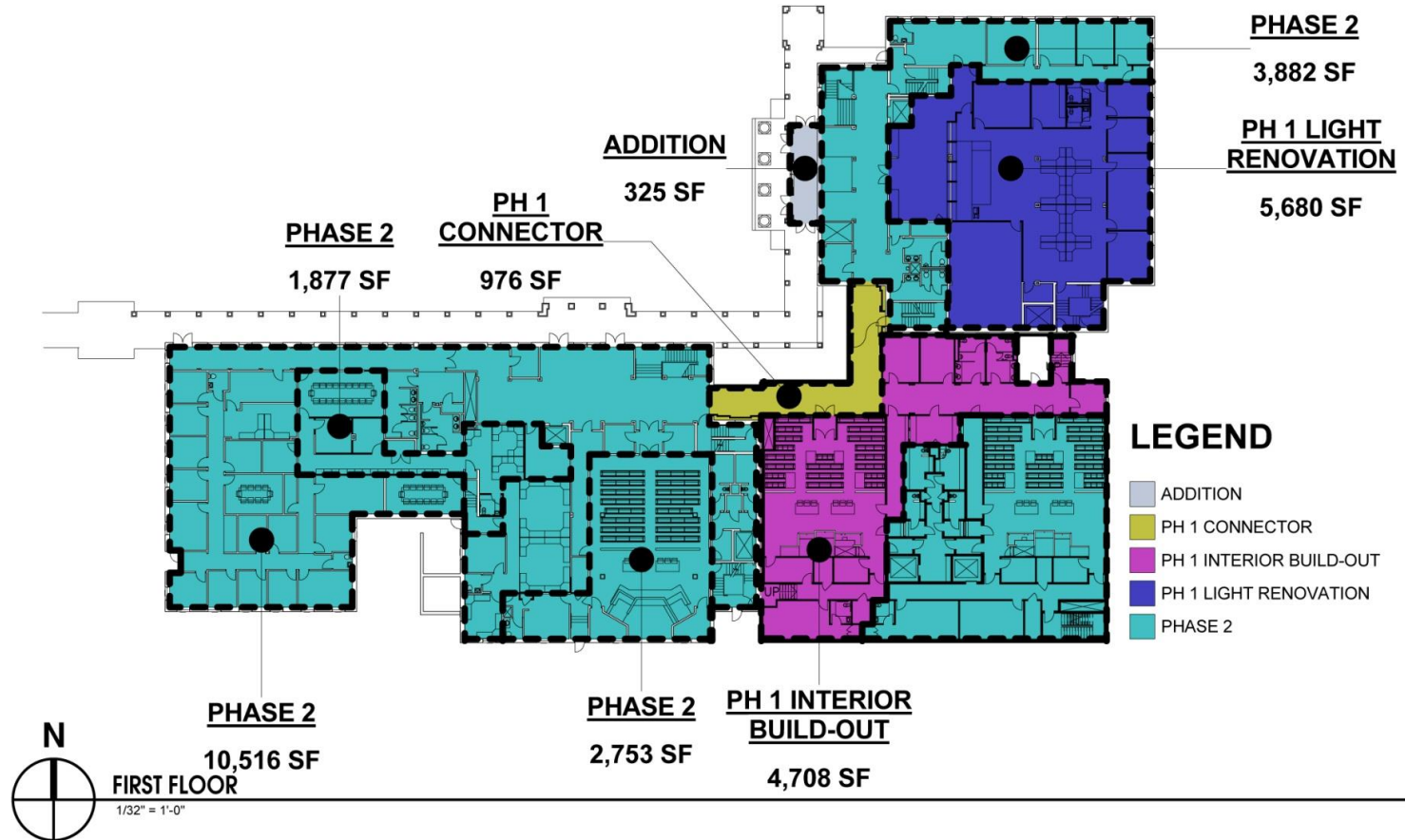

1/7/2016 1:45:01 PM

MOSELEYARCHITECTS

3200 NORFOLK STREET, RICHMOND, VA 23230
PHONE (804) 794-7555 FAX (804) 355-5690
MOSELEYARCHITECTS.COM

Judicial Center Feasibility Study
County of Spotsylvania, Virginia

FIRST FLOOR PLAN - OPTION 1-PHASE 2 ALTERNATE

2.4

Project Cost Summary

- Current Project Budget
 - \$9,564,000
- Estimated Project Cost 2017 Dollars
 - \$9,893,150
- Project design to begin Summer 2017.

General Government Space Needs Update

May 9, 2017

Overall Conceptual Space Needs

- General Government

Need	Square Feet	Deficit
2017	107,600	11,200
2032	124,700	28,300

Current available square footage: 96,400

Key Departments Immediate Need

Department	Immediate Space Need
Social Services	3,000
Information Services	3,100
Commissioner of Revenue	2,000
Various Other Departments	3,100

Does not include Public Safety building or storage/logistics needs.

Space Needs Highlights

Entity	Current Square Footage	2032 Square Footage	Space Deficit
Finance	3,619	4,412	793
Community Development	15,311	17,128	1,817
Rappahannock Area Health District	7,079	12,013	4,934
Sheriffs Office Training Center and Support	2,655	4,233	1,578

Additional Space Available

Building	Work Type	Space Available	Cost
Old Sheriffs Office	Renovation	13,440 sq ft	\$1,500,000*
Merchant Square	Up-fit Unfinished Area	8,000 sq. ft.	\$500,000
Marshall Center	Reconfigure Second Floor Upgrade HVAC/Elec	19,000	\$10,250,000
Holbert Building (Expansion)		4,600 sq ft	\$1,700,160

*Demolition cost is estimated at \$500,000

Future Considerations for Government Services

- Co-location provides optimum customer service
- Ensure adequate parking for the service provided
- Future Co-location Partners
 - County Administration, Finance, IS, County Attorney, Economic Development, Human Resources
 - Social Services, Health Department
 - Visitor Center, Museum, Museum Annex
 - Treasurer, Commissioner of Revenue, Voter Registration